

Slim leather cardholder pattern

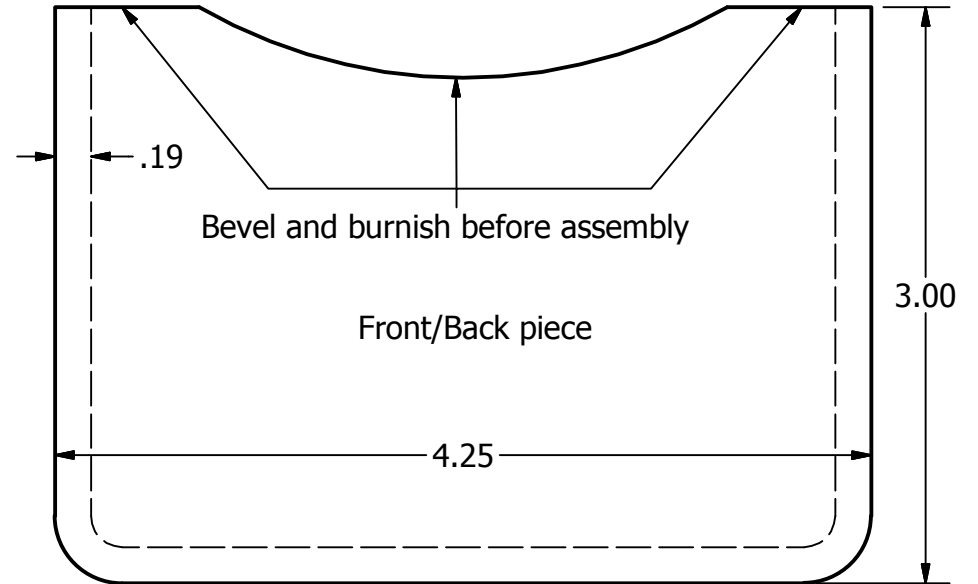

Bevel and burnish before assembly

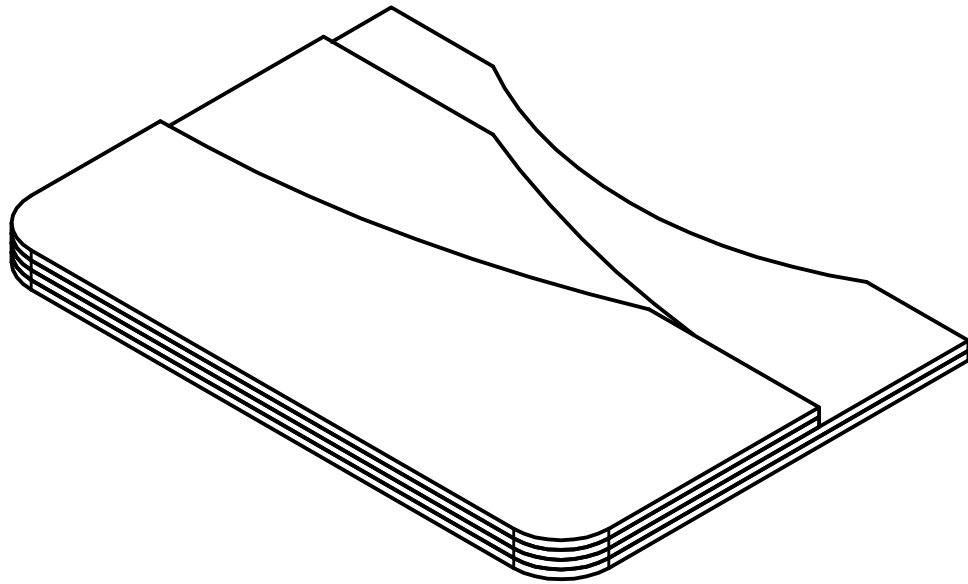
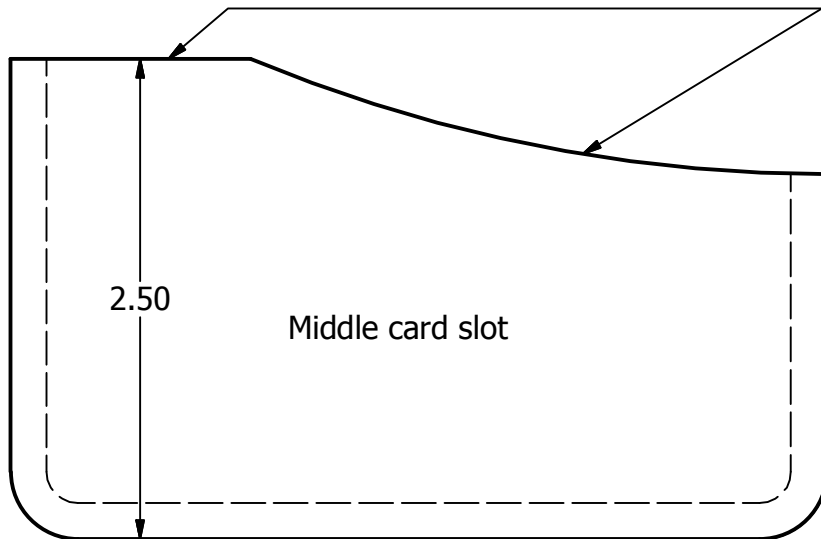

Middle card slot

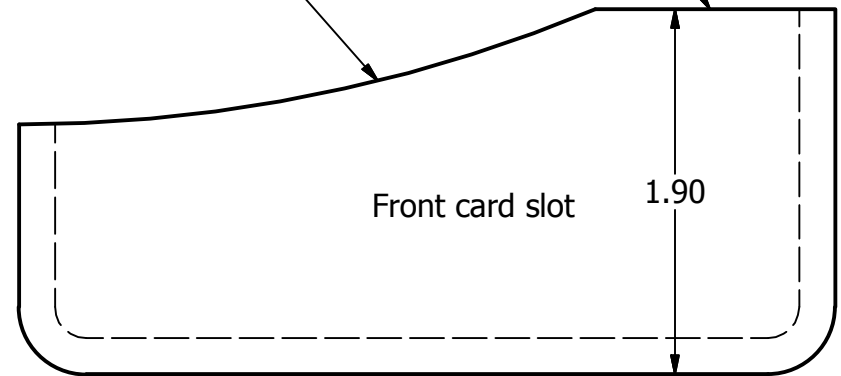

Front card slot

1.90

Print out this pattern at 1:1 and the pieces should be true to size. Use 2 to 4 oz leather for all four pieces. After dyeing (optional) and finishing internal edges (optional), glue pieces in place and sew along dotted line (5mm/stitch). Bevel and burnish the exterior edge after assembly and sewing